

U300-C

3-inch Screen Fingerprint Time Attendance Terminal



Introduction

The firmware of U300-C has been upgraded to the New Firmware. It brings many new experiences, including the new stunning GUI, rock-solid stability, faster matching speed and better expandability.

Users can easily manage data by networking U300-C via RS232/485, TCP/IP, and USB-host. Most importantly, all the functions can still operate in a networking state. U300-C is compatibility with various types of USB flash disks, ADMS and former SDK. It also supports data backup and retrieve to avoid the risk of accidental deletion.

It promotes the fingerprint time & attendance management to the next level. You can get the best of benefits from the U300-C.

Features

Remarkable user experience

- * Intuitive and stunning UI designed with the most popular and internationalized element.
- * Interface operation adopts modularized hierarchical design. Simpler, better and more logical.
- * Faster matching speed: less than 0.5 second.

Enhanced features and performance

- * User validity settings.
- * Data backup and retrieve.
- * Advanced User ID consisted of letters and numbers.
- * Chip encryption for firmware protection.
- * More flexible menu configuration: double line text display.
- * Built-in Serial and Ethernet ports

Excellent expandability

- * Easy to extend functions and customize customers demand.



Specifications

Fingerprint Capacity	3000
ID Card Capacity	10,000 (Optional)
Record Capacity	100,000
Display	3-inch Screen
Communication	RS232/485, TCP/IP, USB-host, USB-client
Standard Functions	SMS, Workcode, DST, Scheduled-bell, Self-Service Query, Automatic Status Switch
Optional Functions	ID/Mifare/HID, 9 digit user ID, Webserver, Photo ID, ADMS
Software	ZKTime 5.0 (Free), ZKTime. Net
Power Supply	DC 5V 2A
Verification Speed	≤0.5 Sec.
Operating Temp.	0°C- 45°C
Operating Humidity	20%-80%
Dimension	181.6*126*49mm (Length*Width*Thickness)
Net Weight	1.2 kg

Dimensions (mm)

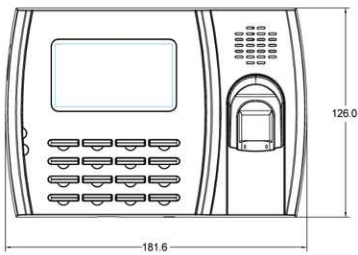

Interface

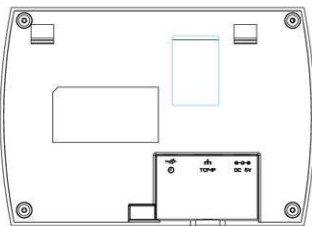

Configuration

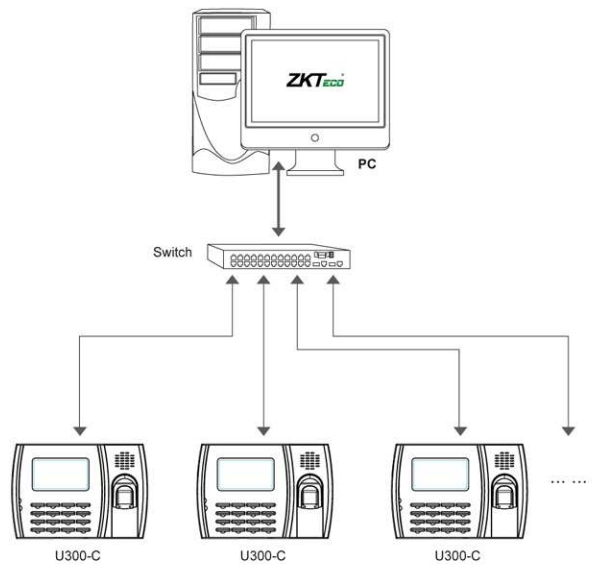

Package List

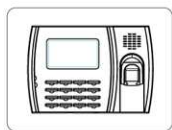

U300-C

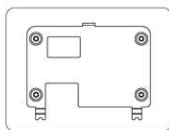

Back Plate



Screws and Holders



Software CD
(ZKTime 5.0)

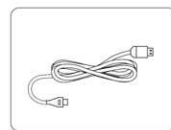

USB Cable

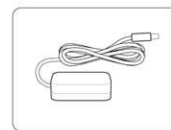

Power Adapter



RJ45to485
Conversion Cable

ZKTeco Inc.

ZK Mansion, Wuhe Rd, Gangtou, Bantian, Buji
Town, Longgang District, Shenzhen China 518129
Tel: 86-755-8960 2345/46/47/48
Fax: 86-755-8960 2675
www.zkteco.com

Global Offices:

USA: +1 732-412-6007
EU: +34 916532891
Brazil: +55 31 2515-8326
Thailand: +66-027199154
Mexico: +52-55-52078969

South Africa: +27 12 259 1047
Egypt: +202-24055541
Dubai: +971 4 6091 310
India: +91 8123536788
Indonesia: +62 21 2921 8949
Vietnam: +84-0169-5813007

